

# EULESS TODAY



Dear Citizens,  
2013 is off with a bang and shows promise for being a great year with lots of exciting changes in our future. The new recycling program will begin in March. We are letting our residents recycle in the manner they choose, while keeping a low rate. Please sign up for a bin or a cart today if you choose. If you want to use blue bags, you don't have to do a thing except continue to recycle.

Euless' CERT program will now be under the Fire Department umbrella with Inspector Vernon Gilmore being the CERT Coordinator. Inspector Gilmore and the FD staff have expressed excitement and enthusiasm about overseeing the program. Their subject matter expertise combined with their enthusiasm about the program is in my mind an unbeatable combination.

Don't forget about the free tours on the second Saturday of the month at Heritage Park. The new museum houses historic treasures and offers a glimpse into the past. Thank you for all that you do to keep BUILDING A BETTER TOMORROW.

*Mary Lib Saleh*

## The Euless City Council

- Mary Lib Saleh *Mayor*
- Tim Stinnford *Place 1*
- Leon Hogg *Place 2*
- Linda Martin *Place 3*
- Donna Mickan *Place 4*
- Glenn Porterfield *Place 5*
- Perry Bynum *Mayor Pro Tem*
- Place 6*

## COMMUNITY NEWS 817-685-1400 [www.eulesstx.gov](http://www.eulesstx.gov)



### Christmas Light Removal

The extreme weather in Texas can damage Christmas lights in a short period of time. To protect your home from possible fire and electrical damages, please remove your outdoor Christmas lights as soon as the holidays are over. This is required by the National Electrical Code, Article 527, Section 527.3-B. If you have questions, please contact Code Services at 817- 685-1509. Your assistance is greatly appreciated!



**"Blue bag, bin or cart?"**  
[www.eulesstx.gov/recycling](http://www.eulesstx.gov/recycling)  
**817-685-1825**

*Euless Today is published by the City of Euless.*

201 N. Ector Dr. ♦ Euless, TX 76039 ♦ 817-685-1400 ♦ [eulesinfo@eulesstx.gov](mailto:eulesinfo@eulesstx.gov) ♦ Euless Cable Channel 16 ♦ [www.EulessTx.gov/MyEuless](http://www.EulessTx.gov/MyEuless)



## HEB Chamber Expo

February 22, 10 a.m. – 3 p.m.  
Hurst Conference Center  
1601 Campus Dr.

Enjoy shopping, free food and drinks at the HEB Chamber Expo. This trade show allows businesses in Hurst, Euless and Bedford to showcase their products and services all under one roof. Tickets to attend are \$10 per person. The Expo is hosted by the HEB Chamber of Commerce and the HEB Economic Development Foundation. Call (817) 283-1521 or visit [www.heb.org](http://www.heb.org) for more information.



## CERT Program Protects Euless Residents

The Community Emergency Response Team is a very valuable resource to our Police and Fire Departments. CERT volunteers support first responders in the event of an emergency by training year-round to mitigate a variety of situations. This ensures professional responders in Euless will have additional assistance in the event of a disaster.

The Euless CERT programs stands out in the region and state as an outstanding group, and it would not be possible without our dedicated volunteers. The CERT Program was previously run out of the Emergency Management office in the Police Department and now will be coordinated by the Fire Department. If you would like to get involved, please call Vernon Gilmore at (817) 685-1604 for more information or to get an application.

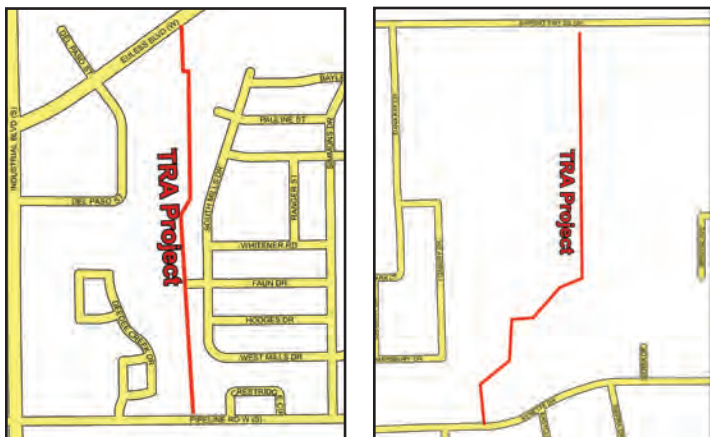

## Wastewater Projects

Beginning in February, the Trinity River Authority (TRA) will begin wastewater line rehab along Boyd Branch, west of Mills Drive between S. Pipeline and SH 10/Euless Blvd. The estimated completion of this project is May 2014.

Also in February, TRA will rebuild wastewater lines along Cyclone Branch west of Wilshire Park between Kynette Drive and SH 183. The estimated project completion is June 2014.





## *Tax Season is Here Again*

Beginning February 2, the Eules Public Library will again welcome AARP volunteers to help individuals and couples prepare their income tax returns. AARP will be in the Library from 4-8 p.m. on Tuesday evenings and from noon-4 p.m. on Saturday afternoons from February 2 through April 13. Reservations are required and must be made in person. For questions, please call the Reference Desk at 817-685-1489. In addition, tax resources and IRS tax forms are available for your use at the Library.



## *Texas Star Valentine's Day Dinner*

*Thursday, February 14, 6 - 9 p.m.*

Discover Eules's best kept secret on Valentine's Day and enjoy a romantic three or four course dinner at Raven's Grille. We will have many wines available to complement your dinner, as well as champagne. Treat that special someone in your life to a delicious and romantic menu offering on Valentine's Day. The Grille will be transformed to a romantic dining room, with candlelit tables and soft music where you will start with your choice of a scrumptious appetizer and salad, move on to a mouthwatering entrée and finish with a heavenly dessert. Make your reservations soon for a very special Valentine's Day dinner by Raven's Grille. Call 817-685-1847 to secure your spot.



## *Eules Resident Golf Discount Days*

Texas Star Golf Course is fun and relaxing and right around the corner. Check out this beautiful course for yourself. We are offering Eules residents the opportunity to play for \$25 which includes cart and range balls.

Eules residents can get this steal of a deal after 11 a.m. on:

- **Tuesday, February 19**
- **Monday, March 11**

Eules residents will need to bring a valid ID to show proof of residence. Tee times can be made four days in advance by calling the Golf Shop at 817-685-7888. Walk-up reservations will be accepted if space is available.



## February Special Events

Senior Center special events are for Eules Family Life Senior Center members. You must be over the age of 60 to become a member.

- |  |                              |                        |
|--|------------------------------|------------------------|
| <b>Grapevine Mills Mall Trip</b><br>Enjoy the sales of the seasons, great bargains and spring sales!   | <b>February 1</b>            | <b>10 a.m.</b>         |
| <b>Pool Tournament</b><br>1-15 tournament, must be a member of EFLSC or a Eules resident to compete. Lunch provided for players.   | <b>February 8</b>            | <b>10 a.m.</b>         |
| <b>Valentine Party with Mr. Rock and Roll</b><br>Everyone wear red that day! Refreshments and snacks provided.   | <b>February 14</b>           | <b>1 p.m.</b>          |
| <b>Titantic Artifact Exhibit</b><br>Cost is \$19.  | <b>February 15</b>           | <b>9:30 a.m.</b>       |
| <b>AARP Driving Class</b><br>\$12 AARP members/\$14 Non-AARP Members. Refresh your driving skills and reduce your insurance rates. Learn about new laws and what you can do to become a safe and friendly driver.                          | <b>February 15</b>           | <b>9 a.m. - 1 p.m.</b> |
| <b>AARP Free Income Tax Prep</b><br>Every Friday from 9 a.m. - 1 p.m. through April 12. Appointments must be made in person at the EFLSC from 8 a.m. - 4 p.m., Monday - Friday. You must pick up your AARP Income Tax packet at that time. | <b>February 8 - April 12</b> | <b>9 a.m. - 1 p.m.</b> |
| <b>Critterman</b><br>Come join us for a Extra Furry Safari with Critterman. See exotic animals like a sugar glider, hedgehog and ferret. You may even have a chance to pet one!  | <b>February 22</b>           | <b>1 p.m.</b>          |

*\*Registration is required for these activities one week prior! Don't wait to register at the last minute. If we do not have enough to make the class or event, we may have to cancel. Some activities have limited space available as well. Sign up today for the activities you are interested in. You may miss out if you wait too long!*



## Join Our Family of Volunteers

The City of Eules Parks & Community Services Department is looking for people that love to have fun, meet new people, and who are willing to branch out into new experiences. If this is you, we would love to have you join our Family of Volunteers Program.

Each year our department plans, implements and produces several different, but unique family events. In order to produce such outstanding events, we need volunteers, because without volunteers, our events would not survive. If you would like to help build a strong community, play an important role in someone's life, and be a part of something exciting, then join our Family of Volunteers. Contact Jerry Poteet at 817-685-1449 or [jpoteet@eulesstx.gov](mailto:jpoteet@eulesstx.gov).





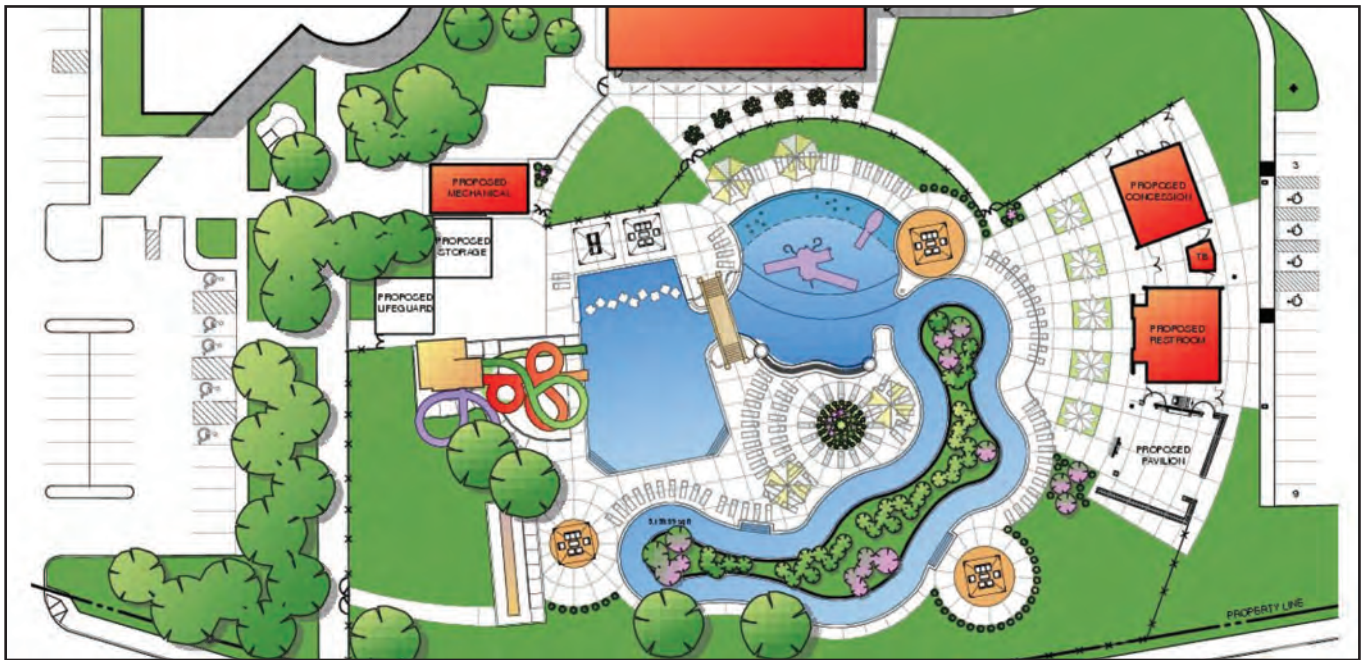

## *New Aquatic Center in Eules*

Construction is well under-way for the new aquatic facilities at the Eules Family Life Center. The outdoor aquatic center, slated to open on Memorial Day weekend in 2013, will feature a lazy river, thrill slides, zero depth entry with a splash structure, shade structures, concession/entry building, pavilion and much more! Vouchers for summer swim passes are on sale now at the front counter of the recreation center. For more information please call 817-685-1666.



## *Free Tours Available*

Free tours of historic Heritage Park are offered on the 2nd Saturday of every month between 1 – 5 p.m.

Come visit the all-new Eules Heritage Museum at the Ruth Millican Center, as well as the Himes Log House, the Fuller House and the McCormick Barn. Come see "HOW WE LIVED." Contact Mary at [ofaiva-siale@eulesstx.gov](mailto:ofaiva-siale@eulesstx.gov) or 817-685-1649. Group tours are available on different days depending on staff availability.



## FEBRUARY CLASSES

*Eules Family Life Center, 300 W. Midway Dr.*

*For complete descriptions, visit [www.eulesstx.gov/eflc](http://www.eulesstx.gov/eflc) or on Facebook "Eules Parks & Community Services."*

**EFLC HOURS: M-TH: 5:30 a.m. - 9 p.m. ♦ FRI: 5:30 a.m. - 8 p.m. ♦ SAT: 8 a.m. - 6 p.m. ♦ SUN: 1 - 6 p.m.**

<u>CHILD DEVELOPMENT</u>	<u>CLASS#</u>	<u>BEG</u>	<u>AGE</u>	<u>DAY</u>	<u>TIME</u>	<u>#WKS/\$</u>
Strolling Striders		2/5	0+	T	9-10am	FREE
Fun Time for Learners	210002-02	2/4	3-5	M/W	9am-1pm	4/\$127
Terrific Tuesday & Thursday	210003-02	2/5	3-5	T/TH	9am-1pm	4/\$127
Fun Time Fridays	210010-02	2/8	3-5	F	9am-1pm	4/\$62
 <u>YOUTH/TEEN ACTIVITIES</u>						
Under the Rim Basketball	210515-02	2/9	5-10	S	10-10:45am	3/\$27
Parents Night Out	211112-02	2/1	6-12	F	6-9pm	1/\$10
Young Spartan Boot Camp	210510-02	2/6	7-13	W	6-7pm	4/\$26
Making the Cut Basketball	210520-04	2/9	7-14	S	10:45-11:15am	3/\$32
Making the Cut Basketball	210520-05	2/9	7-14	S	11:15-11:45am	3/\$32
Making the Cut Basketball	210520-06	2/11	7-14	M	4:30-5:15pm	3/\$42
Girls On The Run	210540-01	2/12	8-12	T/TH	5:30-7pm	10/\$120
Zumbatomic	210316-02	2/4	8-12	M/W	5-6pm	4/\$50
Contemporary Ballet	210230-02	2/18	10+	M/W	7-7:50pm	8/\$90
 <u>ADULT ACTIVITIES</u>						
Modern Dance	210235-02	2/18	12+	M/W	8-8:50pm	8/\$90
Hip Hop Dance	210240-02	2/19	12+	T/TH	7-7:50pm	8/\$90
Boot Camp Cardio	210315-02	2/4	13+	M/TH	6-7pm	4/\$37
Zumba	210300-02	2/4	13+	M/W	7-8pm	4/\$42
Adult Tap Dance	210245-02	2/19	14+	T/TH	8-8:50pm	8/\$90
You Can Oil Paint	210810-02	2/28	14+	TH	6-9pm	1/\$37
Kempo Karate	210135-02	2/6	15+	W	7-9pm	4/\$32
				S	9-11am	
Zumba Toning	210325-02	2/5	15+	T/TH	9:30-10:30am	4/\$50
Pilates Mat	210320-03	2/4	15+	M/W	6-7pm	4/\$50
Pilates Mat	210320-04	2/5	15+	T/TH	10:30-11:30am	4/\$50
Spanish for All	210840-04	2/23	15+	S	8-10am	6/\$122
Hatha Yoga	210330-02	2/5	16+	T/TH	7-8pm	3/\$36
Boot Camp	210350-02	2/5	16+	T/TH/F	5:45-6:45am	4/\$62/\$42
Tai Chi Beginners	210305-02	2/5	16+	T	6-7pm	4/\$40
Tai Chi Advanced	210306-02	2/5	16+	T	7-8pm	4/\$40
Fun Way To Public Speaking	210710-01	2/11	16+	M	7-8:30pm	6/\$32
Social Security: Questions	211004-01	2/21	18+	TH	10-11:30am	1/FREE
 <u>DR PEPPER STARCENTER</u>						
	<i>1400 S. Pipeline, 76040, 817-267-4233</i>					
Tot Ice Skating	211161-02	2/23	3-4	S	11:15-11:45am	2/\$30
Skate Like a Star	211162-03	2/12	5-13	T	6:45-7:15pm	2/\$30
Skate Like a Star	211162-04	2/23	5-13	S	11:15-11:45am	2/\$30
Adult Ice Skating	211165-02	2/12	14+	T	6:45-7:15pm	2/\$30
 <u>SIMMONS ACTIVITY CENTER</u>						
	<i>508 Simmons Dr., 76040</i>					
Hapkido	210133-02	2/4	13+	M	7:30-9pm	4/\$26
Urban Boot Camp	210340-02	2/4	13+	M/W	5:30-6:30am	4/\$65
				S	7:30-8:30pm	